

Suggested Print Parameters

0.2 mm layer height
0.4 mm nozzle width
80% infill
heat resistant material (PETG, ABS, etc.)
Normal Support

BERD Air tube note: I mount the tube by reaming the hole for a snug but firm fit. Once the ring portion is snug against the E3D sock, I simply slip a small ring of tubing down to the top of the hole to retain the positioning.

Materials

- 3 Mounting screws or bolts
- 1 small screw or bolt for accessory tab
- Zip ties for wire restraint
- Pancake stepper motor
- Titan Aero Kit

A small spacer may be needed for certain stepper motors although the shaft may be shorter, so the spacer should not be too thick.

This screw or bolt will be slightly small than the stock mount screws due to a smaller hole in the accessory tab.

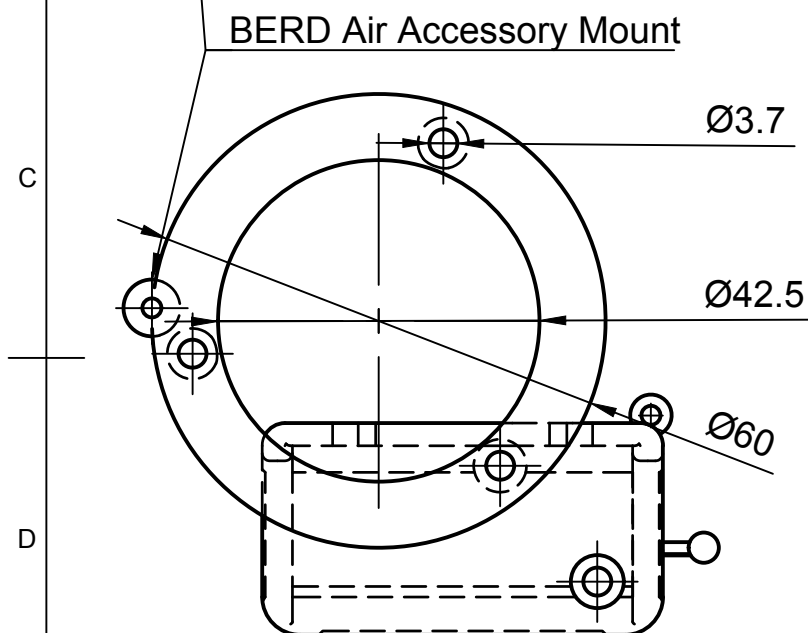

Rostock MAX v2 Titan Aero Mount

This mount works fine for me on my Rostock MAX v2 with an aluminum effector platform from 713maker. It is unconventional in that it uses an accessory tab (normally used to mount a part cooling fan) to help support the stepper motor more rigidly. There is a small accessory hole that can be reamed out to hold a BERD Air tube or ring. However, this might be modified to support other accessories.

I also added a post along the side to facilitate wire restraint. There is also a small ring to allow the thermistor/PT100 wires to be restrained away from the heater cartridge wires.

Support is needed for this print. I have some ideas to change the design to minimize it, but in its current iteration, it is still required.

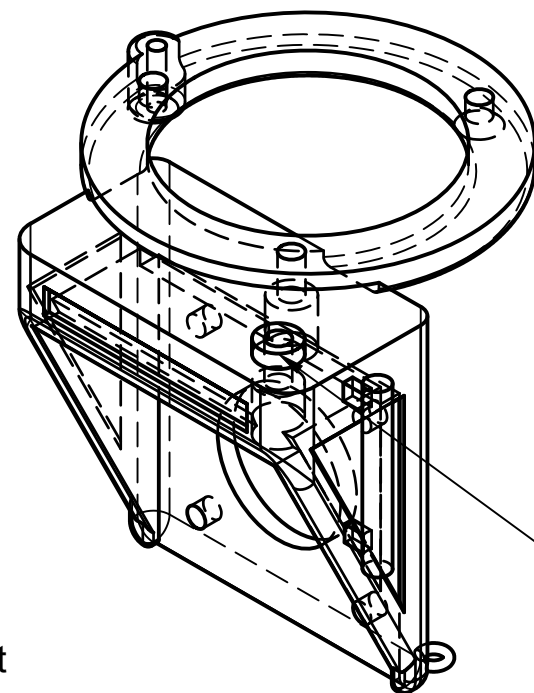

A small spacer will be needed to use this mount with the stock effector.

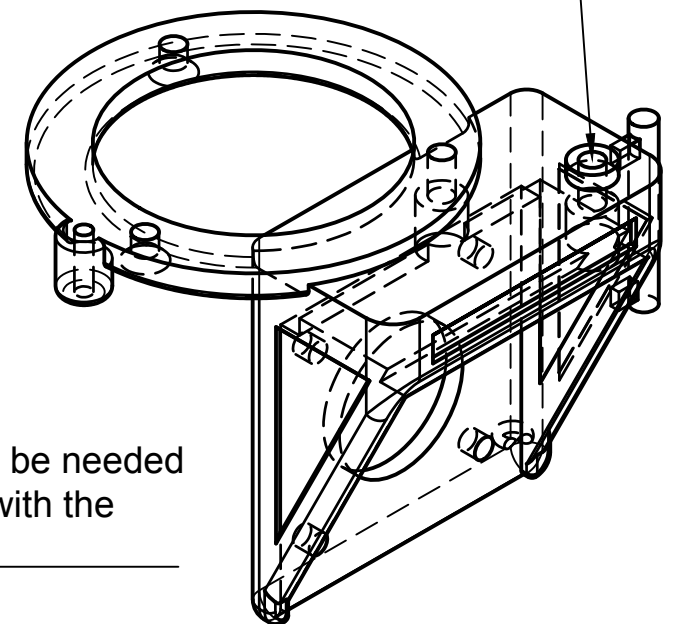

Dept. None	Technical reference 0000	Created by Dionysus480	Approved by		
		Document type Informational	Document status Work in Progress		
		Title E3D Titan Aero Mount Rostock MAX v2	DWG No. 0001		
			Rev. 9.1	Date of issue 5.22.17	Sheet 1/1